

Price Index



5 Widths  
3 Bending Radii



Mounting bracket with  
integrated strain relief



Adapter plate for rapid  
installation



Small Energy Chain®  
internal dimensions .28 x  
.28 (7mm x 7mm)

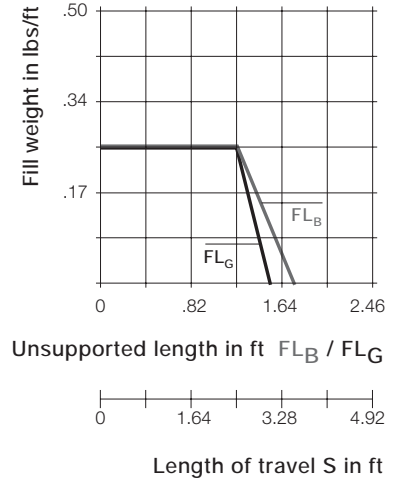

Unsupported length

- FL<sub>B</sub> = unsupported with permitted sag
- FL<sub>G</sub> = unsupported with straight upper run

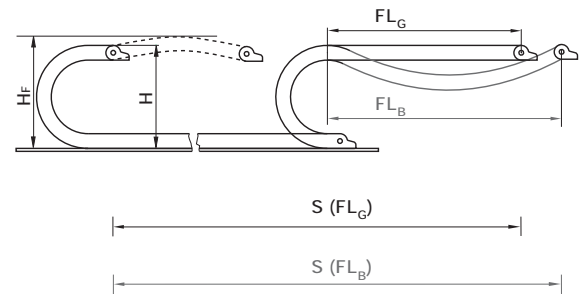

Product Range:

Inner Widths (Bi) inches (mm):	.28 (7), .39 (10), .63 (16), .79 (20), 1.18 (30),
Bending Radii (R) inches (mm):	.59 (015), .71 (018), 1.10 (028), 1.50 (038), 1.89 (048)
Pitch:	.66 (16.7 mm)/link = 1 18.28 links/ft (60 links/m)



When to use the Series 04 E2  
"micro":

- If quieter operation is required
- If cost is a factor
- If snap-open links are not necessary



When not to use the Series  
04 E2 "micro":

- If snap-open links are required
  - ▶ Series 047 "Zipper", Chapter 3
- If quick insertion of cables with pre-assembled connectors is required
  - ▶ Series E04 "E-Z Chain", Chapter 2



# Series 04 E2 "micro"

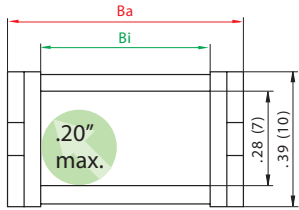

Part No.	Bi	Ba	Bending Radii for ALL Widths	
04-07	.28 (7)	.47 (12)		.59 (015)
04-10	.39 (10)	.59 (15)		.71 (018)
04-16	.63 (16)	.83 (21)		1.10 (028)
04-20	.79 (20)	.98 (25)		1.50 (038)
04-30	1.18 (30)	1.38 (35)		1.89 (048)

Supplement part number with required radius  
for example 04-07-038-0

## Installation Dimensions

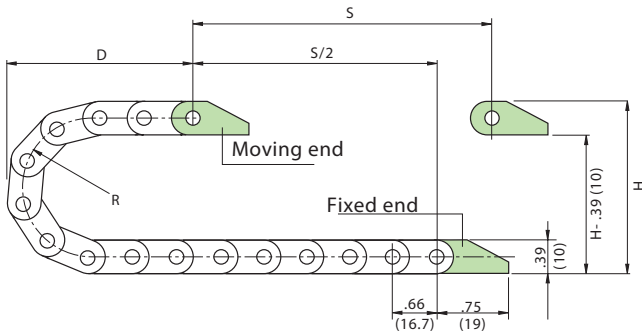

R	.59 (015)	.71 (018)	1.10 (028)
H*	1.65 (42)	1.89 (48)	2.68 (68)
D	1.57 (40)	1.57 (40)	1.97 (50)
K	3.15 (80)	3.54 (90)	4.92 (125)

R	1.50 (038)	1.89 (048)	
H*	3.46 (88)	4.25 (108)	
D	2.36 (60)	2.76 (70)	
K	6.10 (155)	7.28 (185)	

\*The required clearance height is  $HF = H + .20$  (5) with .07 lbs/ft (0.1 kg/m) fill weight. Please consult igus if space is particularly restricted.

Pitch: = .66 (16.7 mm) per link  
 Links per ft (m): = 18.28 links/ft (60 links/m)  
 Chain length: =  $\frac{S}{2} + K$

## Mounting Brackets

### Polymer, One Piece

- One-piece, locked mounting bracket
- Corrosion resistant
- Available pre-assembled
- Inner and outer attachment possible

04....1  
Moving end



04....2  
Fixed end

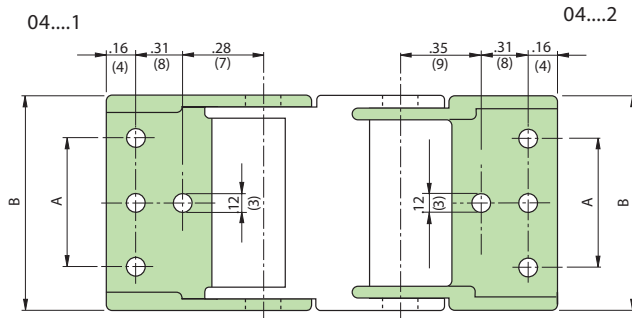

040-07-12 – 040-20-12:  
Center bores only  
040-30-12 :  
Outer bores only



Chain Type	Part No. Full set	Dimension A		Dimensions B	
		in.	(mm)	in.	(mm)
04-07	040-07-12	—	—	.47	(12)
04-10	040-10-12	—	—	.59	(15)
04-16	040-16-12	—	—	.83	(21)
04-20	040-20-12	—	—	.98	(25)
04-30	040-30-12	.87	(22)	1.38	(35)

04...12 = Full set, each part with pin/bore

04... 1 = Mounting bracket with bore

04... 2 = Mounting bracket with pin

## Order example

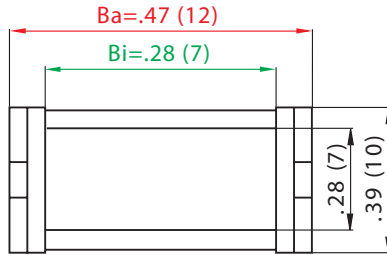

## 04-07...

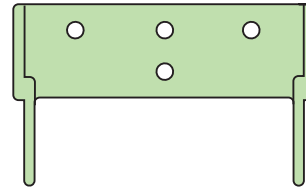

### 1. Chain selection:

04-07-038-0



### 2. Mounting brackets:

040-07-12



For 2.62 ft (0.8 m) chain, color black, with mounting brackets:  
2.62 ft (0.8 m) 04-07-038-0 and 040-07-12

48 links — 18.28 links/ft (60 links/m)

[Click Here for  
Specs &  
CAD Files](#)

## Technical data

Chain Type	Weight Per Link		Weight	
	(oz.)	(g)	(lbs/ft)	(kg/m)
04-07	0.042	(≈ 1.19)	0.048	(≈ 0.071)
04-10	0.044	(≈ 1.25)	0.065	(≈ 0.096)
04-16	0.047	(≈ 1.33)	0.072	(≈ 0.107)
04-20	0.058	(≈ 1.64)	0.085	(≈ 0.126)
04-30	0.072	(≈ 2.04)	0.106	(≈ 0.158)

Material	igumid G
Permitted temperature	-40°F/266°F (-40°C/+130°C)
Gliding speed max.	9.8 ft/s (3 m/s)
Unsupported v max.	32.8 ft/s (10 m/s)
Flammability class	VDE 0304 IIC UL94 HB

● Details of material properties

▶ Design, Chapter 1